

METAL WAINSCOT INSTALLATION

SIGNATURE & SUMMIT SERIES SHEDS

v1 - MARCH 1, 2016

PLEASE



**READ THIS ENTIRE GUIDE
CAREFULLY PRIOR TO
STARTING INSTALLATION**

BEFORE PROCEEDING ENSURE:

**ALL WALLS ARE LEVEL, PLUMB, AND SQUARE.
ALL DOORS ARE INSTALLED PROPERLY.**

CALL US WITH QUESTIONS!

1-888-900-3933

TABLE OF CONTENTS:

METAL TRIM AND FLASHING OVERVIEW	0.2
DRIP EDGE INSTALLATION	1-2
DOOR TRIM INSTALLATION	3-4
CORNER CAP INSTALLATION	5
METAL WAINSCOT INSTALLATION	5-10

METAL TRIM AND FLASHING KEY:

B 2x4 FRAMING CORNER CAP

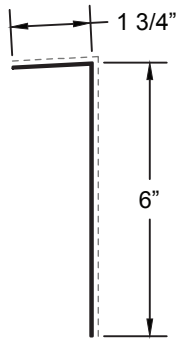

H 2x6 FRAMING CORNER CAP

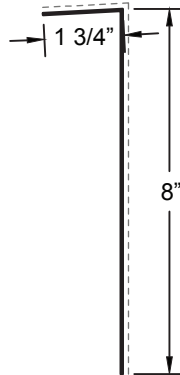

C SIGNATURE & SUMMIT BASE DRIP EDGE

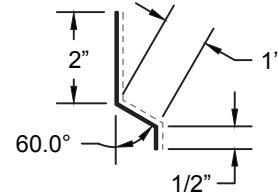

M METAL WAINSCOT J-CHANNEL

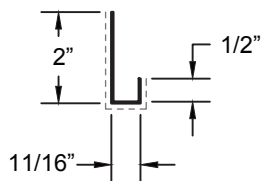

L METAL WAINSCOT Z-CHANNEL

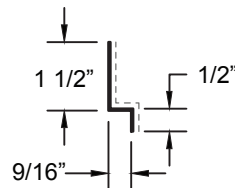

G HARDIE SIDING J-CHANNEL

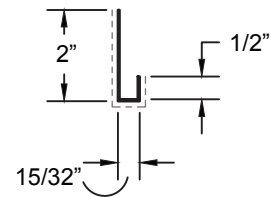

O BEETLE KILL J-CHANNEL

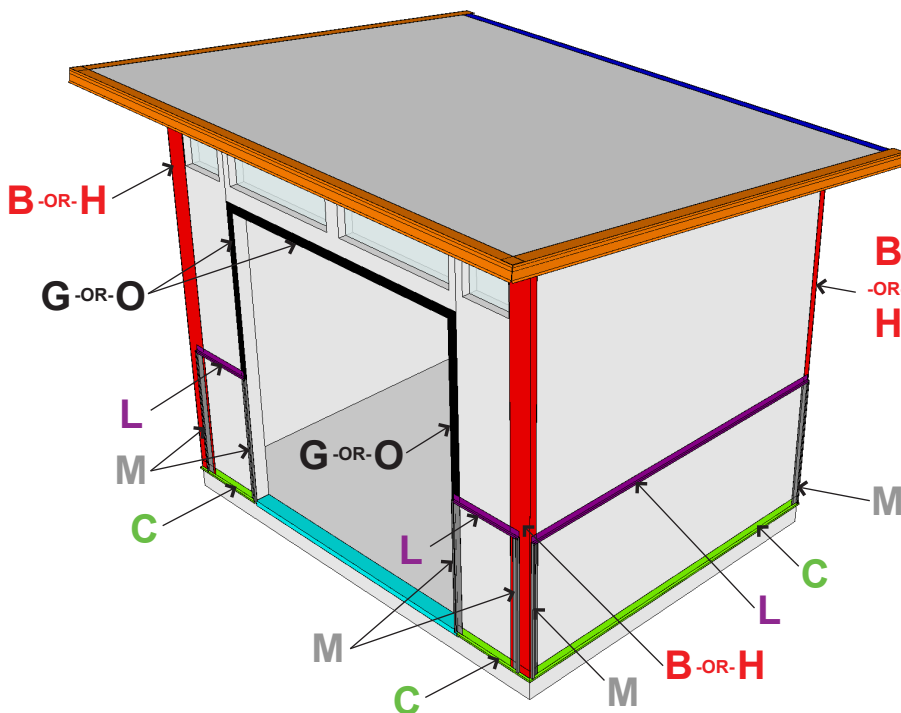
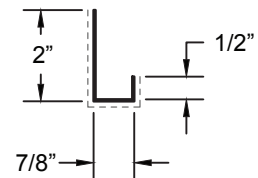

Fig 1a:



ENSURE THAT ALL OF THE STEPS IN THE BUILDING SHELL INSTALLATION GUIDE ARE COMPLETE AND THE DOOR(S) ARE INSTALLED PRIOR TO STARTING THE SIDING INSTALLATION.

CALL US WITH ANY QUESTIONS: 1-888-900-3933

Fig 1b:

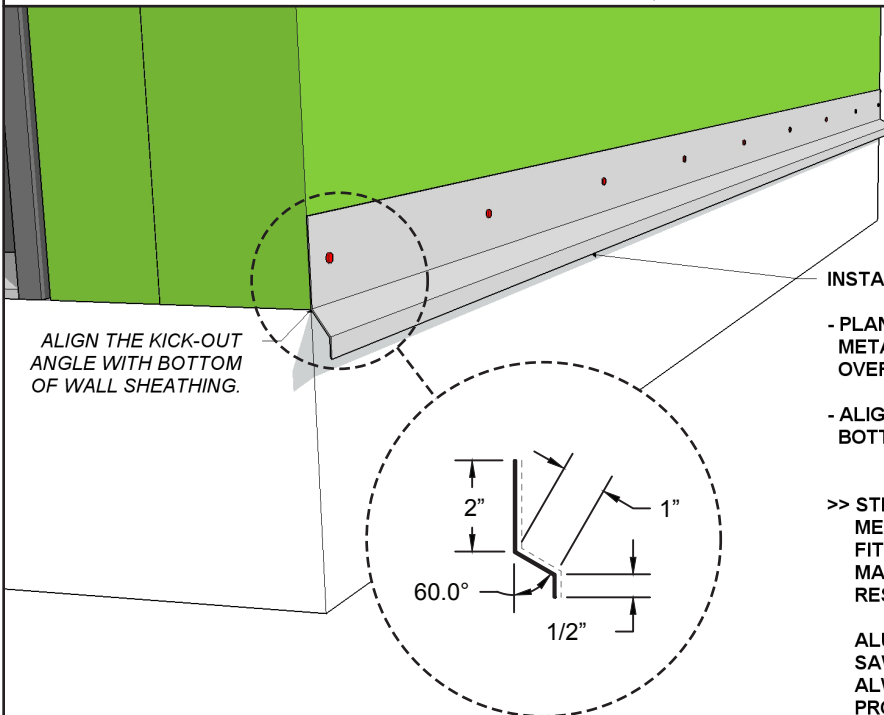

ALIGN THE KICK-OUT ANGLE WITH BOTTOM OF WALL SHEATHING.

INSTALL BASE DRIP EDGE (TRIM PROFILE 'C'):

- PLAN THE SPLICE LOCATIONS, IF MULTIPLE PIECES OF METAL ARE USED, IN THE LEAST VISIBLE LOCATIONS. OVERLAP THE METAL 2-3".
- ALIGN THE KICK-OUT ANGLE OF THE FLASHING WITH THE BOTTOM OF THE WALL SHEATHING.

>> STEP 1:
MEASURE THE BUILDING WALL AND CUT THE TRIM TO FIT. THE DRIP EDGE MEETS UP AT BUILDING CORNERS. MAKE ALL CORNER CUTS 45° MITER CUTS FOR BEST RESULTS.

ALUMINUM CAN BE CUT USING A HACKSAW OR CHOP SAW WITH A HIGH TOOTH COUNT CARBIDE BLADE. ALWAYS WEAR THE APPROPRIATE EYE AND EAR PROTECTION!

>> STEP 2:
USE A PNEUMATIC BRAD NAILER, WITH 3/4" GALVANIZED BRAD NAILS, TO SECURE THE DRIP EDGE TO THE SHED. NAIL ~12" ON CENTER ALONG VERTICAL LEG OF DRIP EDGE. USE A CARPENTER'S LEVEL TO ENSURE DRIP EDGE REMAINS LEVEL DURING INSTALLATION.

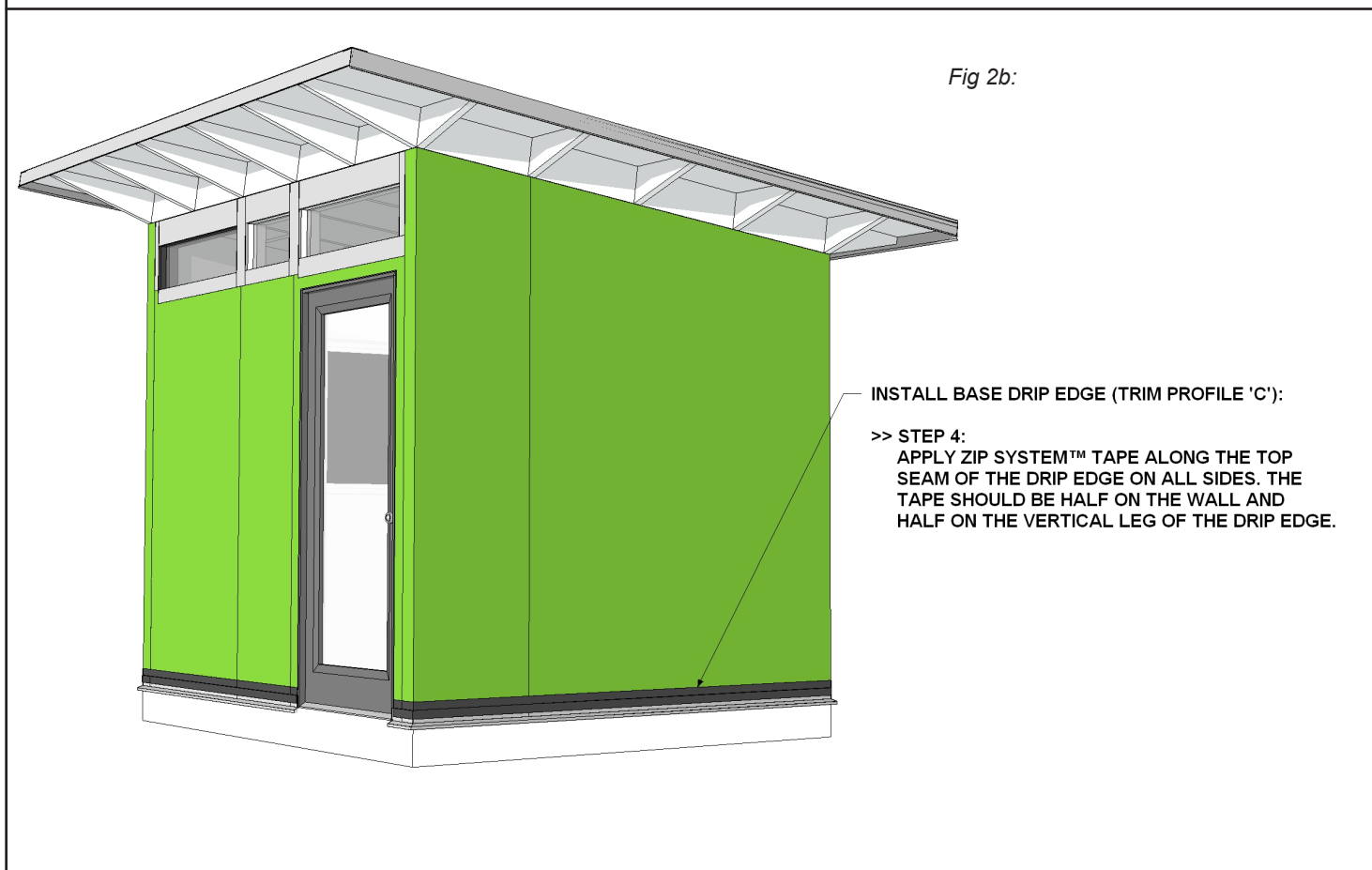
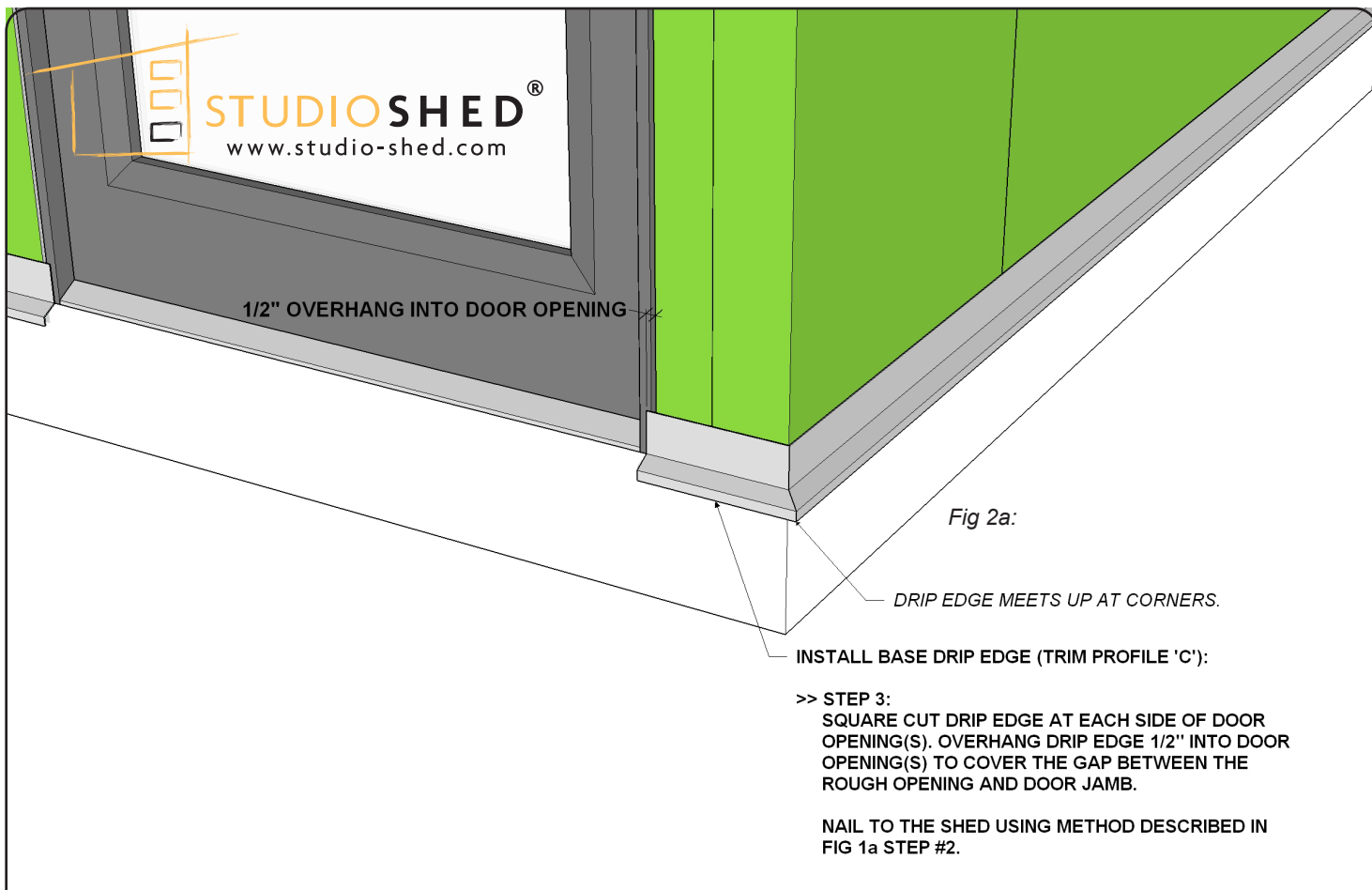

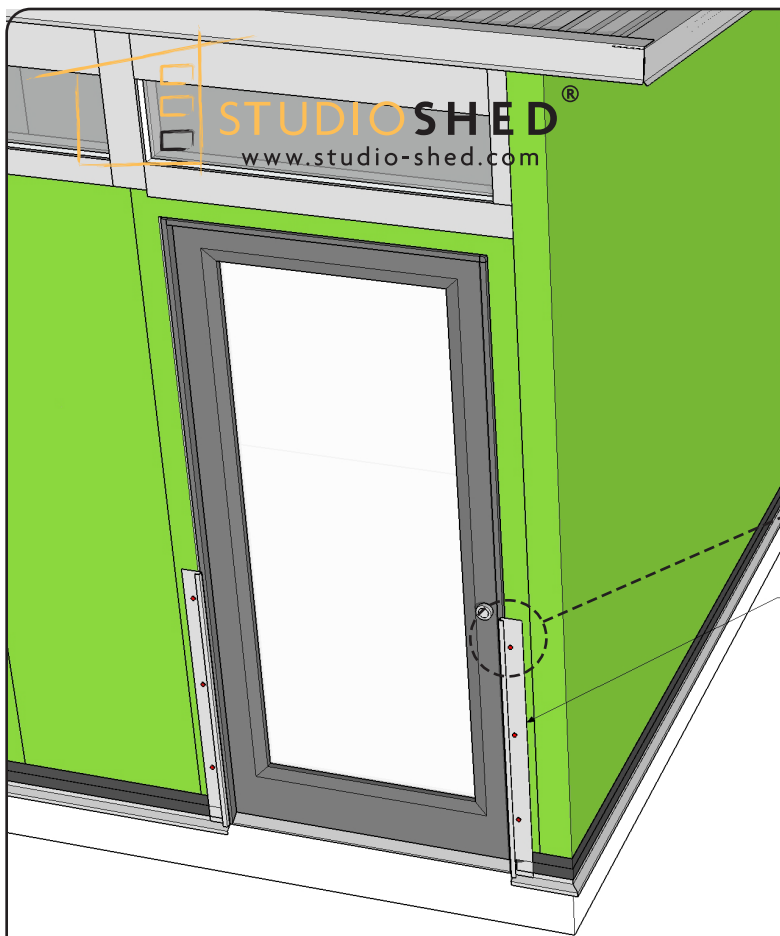
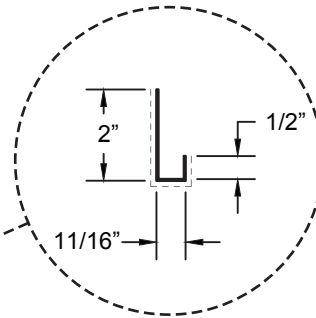

Fig 3a:



INSTALL METAL TRIM AROUND DOOR(S):

>> STEP 1:

INSTALL PRE-CUT 3'-0" LONG METAL WAINSCOT J-CHANNEL (TRIM PROFILE 'M') AT THE BOTTOM OF THE DOOR OPENING(S).

BOTTOM OF THE TRIM WILL START WHERE THE BASE DRIP EDGE KICKS OUT (BOTTOM OF WALL SHEATHING). TRIM WILL EXTEND 1/2" INTO ROUGH DOOR OPENING AND WILL OVERLAP DOOR JAMB ~1/4".

USE A PNEUMATIC BRAD NAILER, WITH 3/4" GALVANIZED BRAD NAILS, TO SECURE THE TRIM TO THE SHED. NAIL ~12" ON CENTER ALONG THE LONG LEG OF THE TRIM. USE A CARPENTER'S LEVEL TO ENSURE TRIM REMAINS LEVEL DURING INSTALLATION.

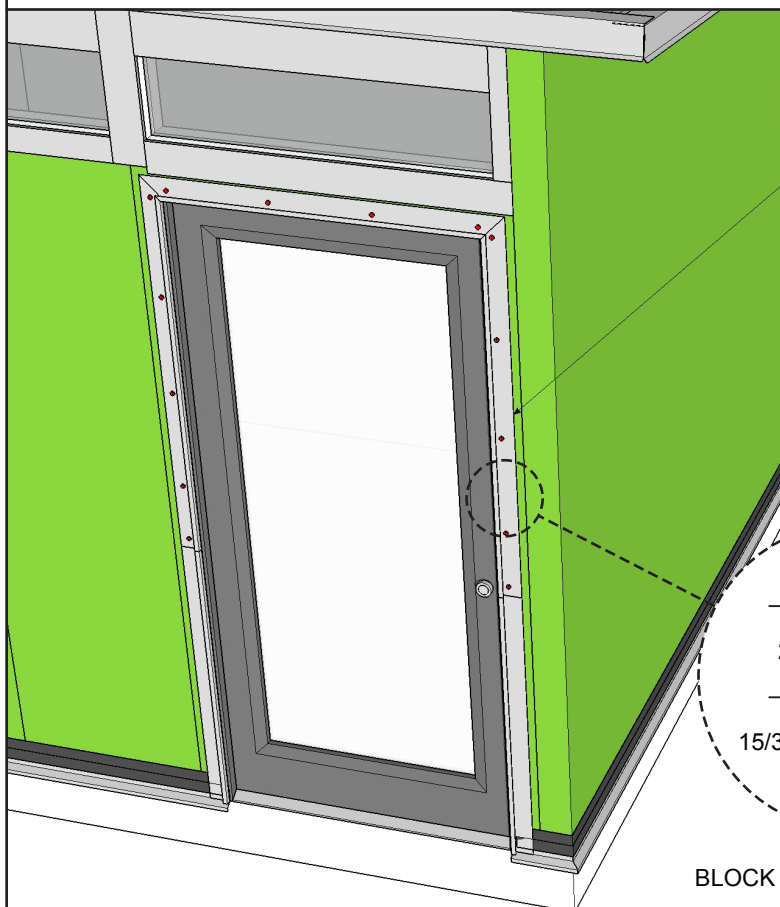

Fig 3b:

INSTALL METAL TRIM AROUND DOOR(S):

>> STEP 2:

INSTALL PRE-CUT DOOR CASING J-CHANNEL (TRIM PROFILE 'G' OR 'O') AROUND DOOR OPENING.

TRIM WILL EXTEND 1/2" INTO ROUGH DOOR OPENING AND WILL OVERLAP DOOR JAMB ~1/4" ALL AROUND.

USE A PNEUMATIC BRAD NAILER, WITH 3/4" GALVANIZED BRAD NAILS, TO SECURE THE TRIM TO THE SHED. NAIL ~12" ON CENTER ALONG THE LONG LEG OF THE CASING. USE A CARPENTER'S LEVEL TO ENSURE TRIM REMAINS LEVEL DURING INSTALLATION.

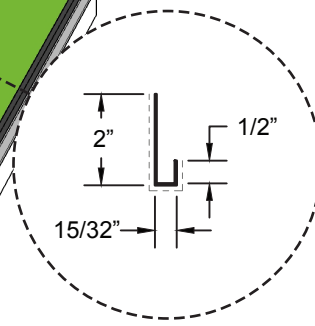

PROFILE 'G'
BLOCK AND PLANK SIDING

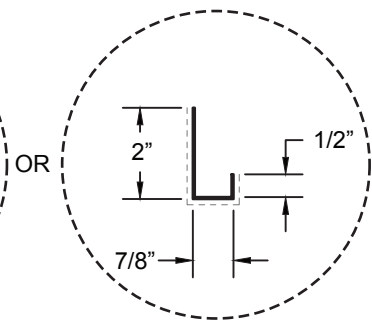

PROFILE 'O'
BEETLE KILL SIDING

Fig 4a:

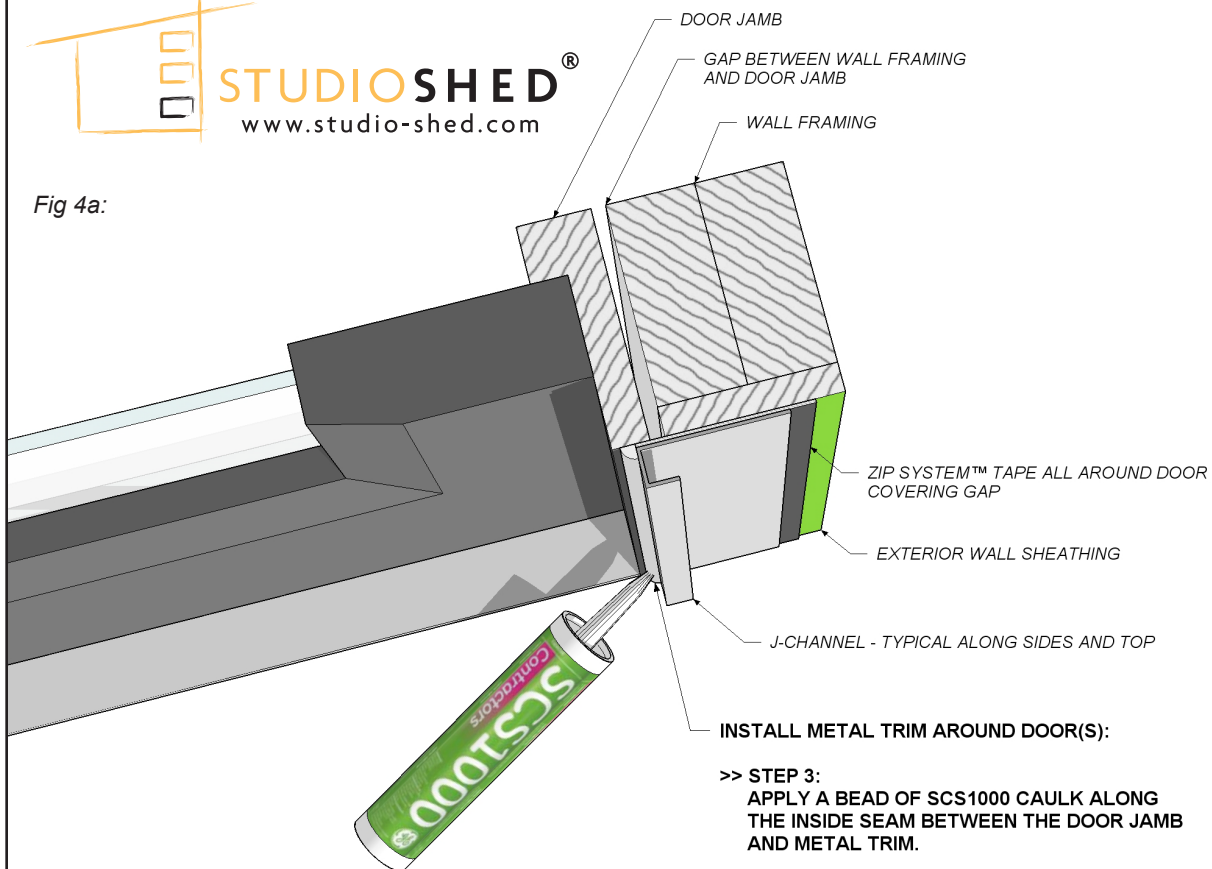

Fig 4b:

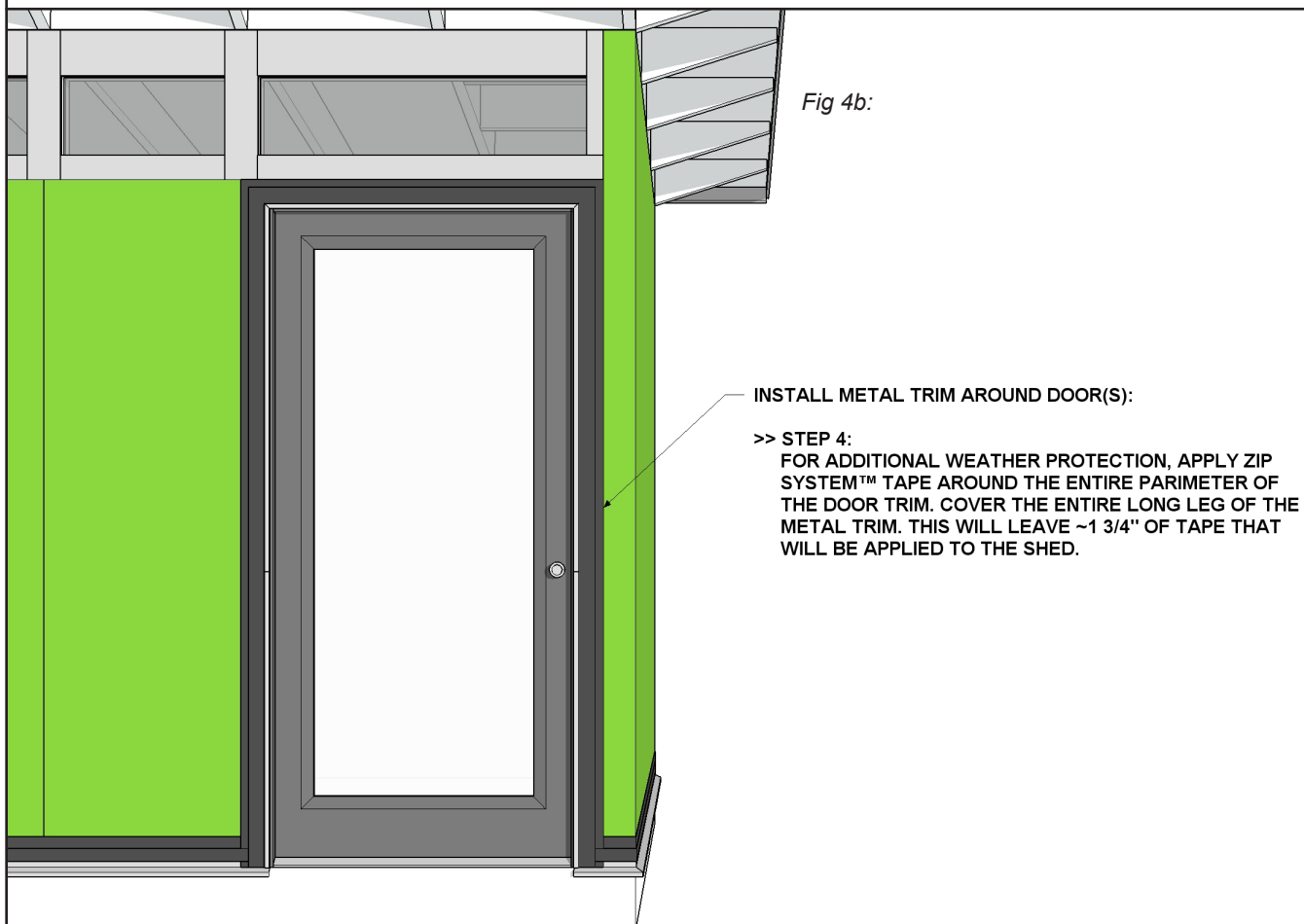
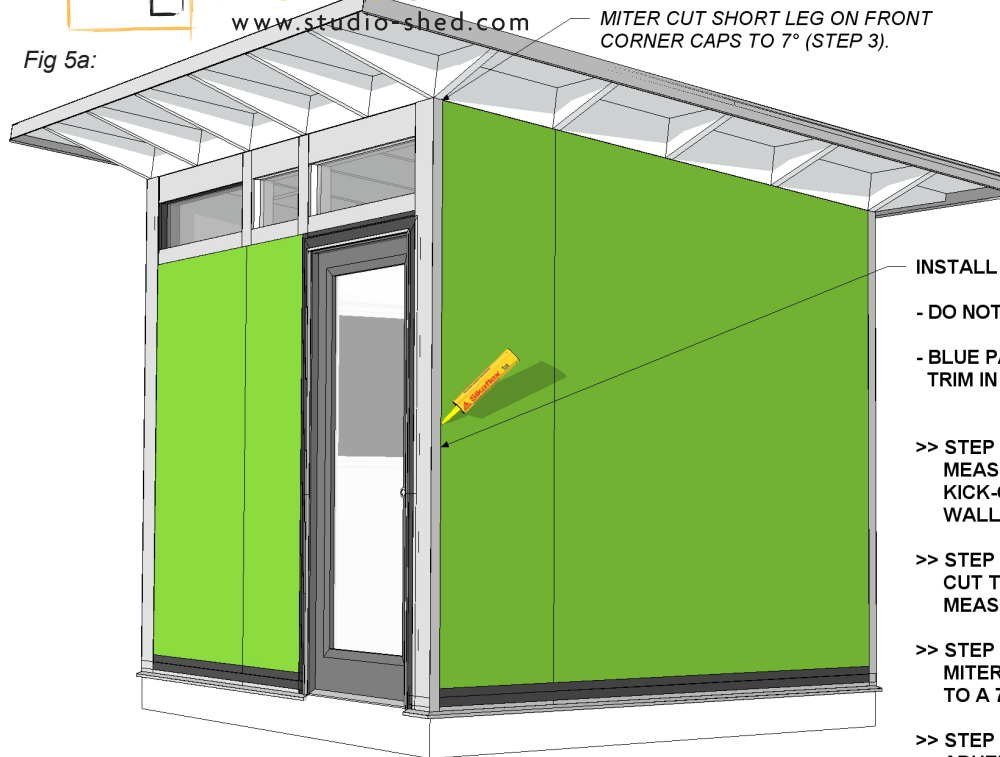

Fig 5a:



MITER CUT SHORT LEG ON FRONT CORNER CAPS TO 7° (STEP 3).

INSTALL CORNER CAPS (TRIM PROFILE 'B' OR 'H'):

- DO NOT USE NAILS TO SECURE!
- BLUE PAINTERS TAPE MAY BE USED TO HOLD THE TRIM IN PLACE WHILE THE ADHESIVE DRIES.

- >> STEP 1:
MEASURE EACH CORNER FROM THE TOP OF THE KICK-OUT ON THE DRIP EDGE TO THE TOP OF THE WALL SHEATHING.
- >> STEP 2:
CUT THE FOUR CORNER CAPS TO THE LENGTHS MEASURED DURING STEP 1.
- >> STEP 3:
MITER CUT SHORT LEG, ON FRONT CORNER CAPS, TO A 7° ANGLE TO MATCH THE ROOF SLOPE.
- >> STEP 4:
ADHERE THE CORNER CAP TO THE SHED BY APPLYING SIKAFLEX ADHESIVE TO THE BACKSIDE OF THE METAL. THE SHORT LEG OF THE TRIM WILL BE ON THE SIDE WALLS.

Fig 5b:

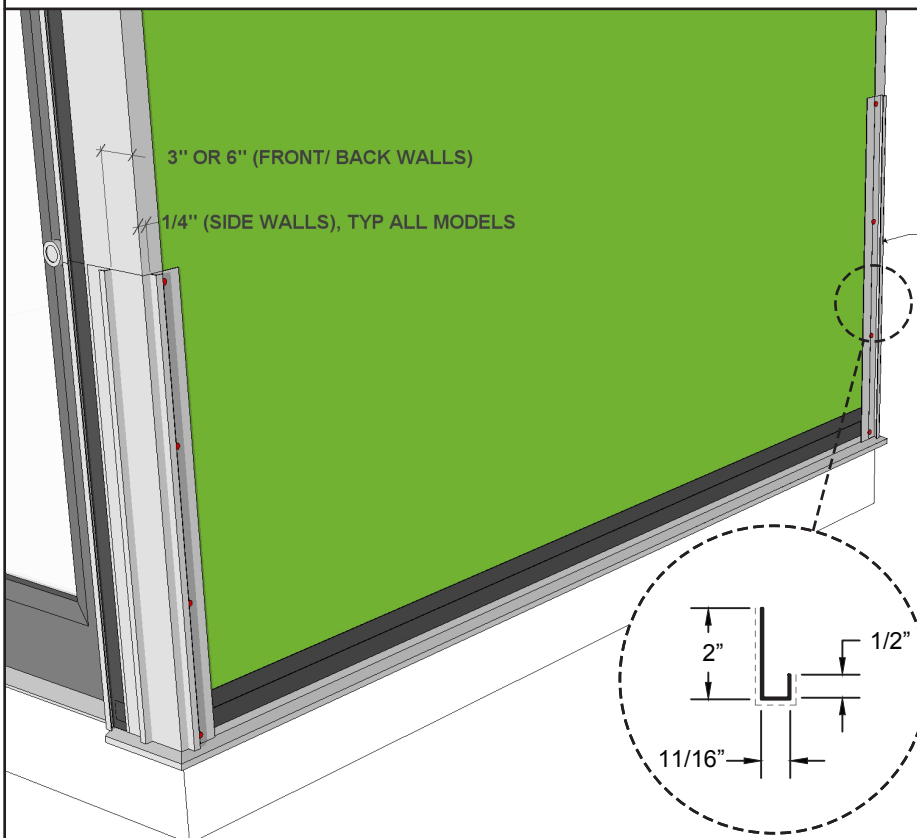

3" OR 6" (FRONT/ BACK WALLS)

1/4" (SIDE WALLS), TYP ALL MODELS

INSTALL METAL WAINSCOT:

- REFERENCE PROJECT INSTALLATION DRAWINGS FOR PROJECT SPECIFIC SIDING LAYOUT AND DIMENSIONS.

- >> STEP 1:
INSTALL THE METAL WAINSCOT J-CHANNEL (TRIM PROFILE 'M') AT ALL BUILDING CORNERS.

J-CHANNEL DISTANCE FROM CORNERS:

1. SIDE WALLS:
SIGNATURE SERIES - 1/4" FROM CORNERS
SUMMIT SERIES - 1/4" FROM CORNERS
2. FRONT AND BACK WALLS:
SIGNATURE SERIES - 3" FROM CORNERS
SUMMIT SERIES - 6" FROM CORNERS

USE A PNEUMATIC BRAD NAILER, WITH 3/4" GALVANIZED BRAD NAILS, TO SECURE THE TRIM TO THE SHED. NAIL ~12" ON CENTER ALONG THE LONG LEG OF THE TRIM. USE A CARPENTER'S LEVEL TO ENSURE TRIM REMAINS LEVEL DURING INSTALLATION.

Fig 6a:

WAINSCOT TO BE FLUSH WITH TOP OF J-CHANNEL.

INSTALL METAL WAINSCOT:

>> STEP 2:
STARTING AT ONE SIDE, INSTALL THE FIRST PIECE OF PRE-CUT CORRUGATED METAL WAINSCOT. THE WAINSCOT WILL SLIDE INTO THE J-CHANNEL INSTALLED DURING FIG 5b.

THE WAINSCOT WILL SIT ON TOP OF WHERE THE BASE DRIP EDGE KICKS-OUT (BOTTOM OF WALL SHEATHING). IN ADDITION IT WILL BE FLUSH WITH THE TOP OF THE J-CHANNEL.

Fig 6b:

INSTALL METAL WAINSCOT:

- USE A CARPENTERS LEVEL TO ENSURE WAINSCOT IS LEVEL PRIOR TO INSTALLING ANY FASTENERS.
- DO NOT OVER DRIVE THE SCREWS! THIS WILL CAUSE DAMAGE TO THE NEOPRENE WASHER.

>> STEP 3:
STARTING AT THE SIDE CLOSEST TO THE BUILDING CORNER, INSTALL THREE 1" NEOPRENE WASHER SCREWS.

PLACE THE SCREWS IN THE CORRUGATED METAL VALLEY, CLOSEST TO THE J-CHANNEL, 1" FROM THE TOP AND BOTTOM AS WELL AS IN THE MIDDLE OF THE WAINSCOT PANEL.

>> STEP 4:
INSTALL THREE ADDITIONAL 1" NEOPRENE WASHER SCREWS FIVE VALLEYS (~10 1/2") OVER FROM THE SCREWS INSTALLED DURING STEP 3.

LINE-UP SCREWS HORIZONTALLY WITH SCREWS INSTALLED DURING STEP 3 FOR THE BEST LOOK.

Fig 7a:

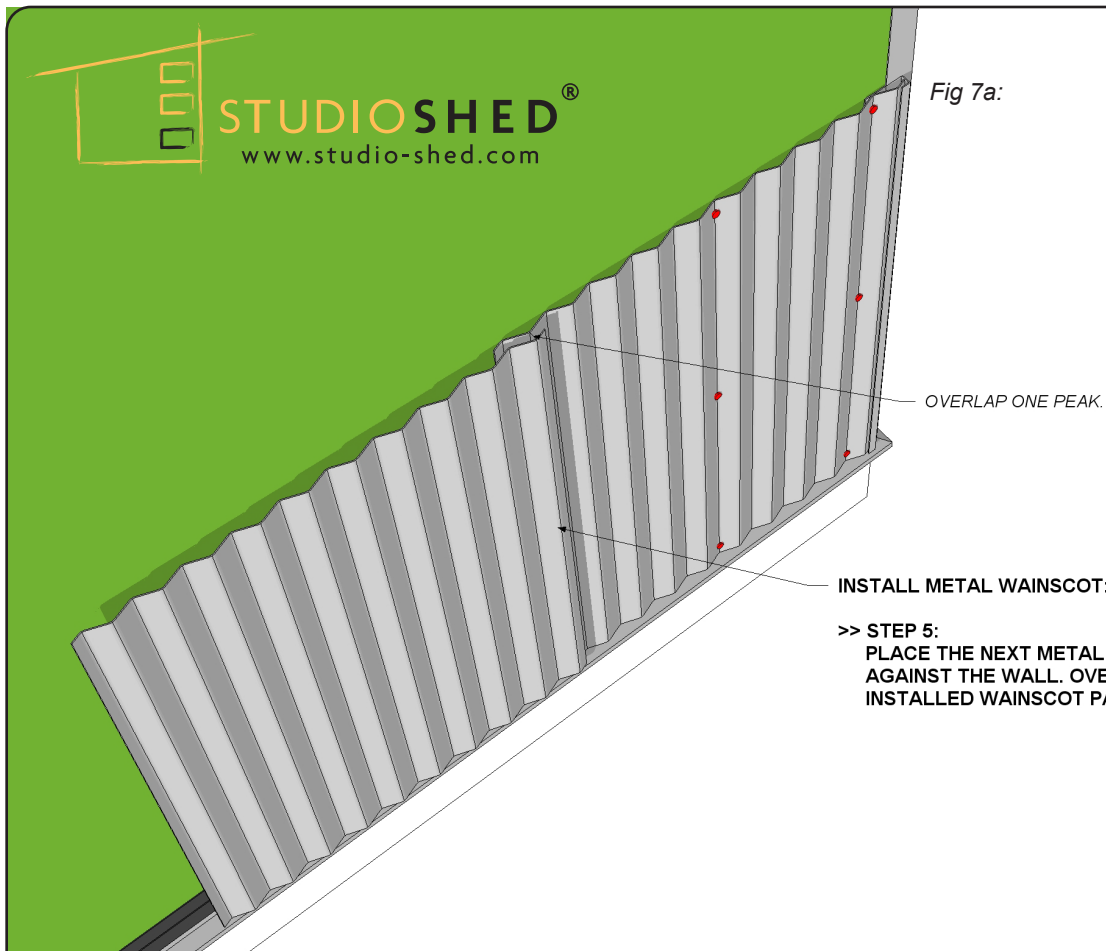

INSTALL METAL WAINSCOT:

>> STEP 5:

PLACE THE NEXT METAL WAINSCOT PANEL AGAINST THE WALL. OVERLAP THE ALREADY INSTALLED WAINSCOT PANEL BY ONE PEAK.

Fig 7b:

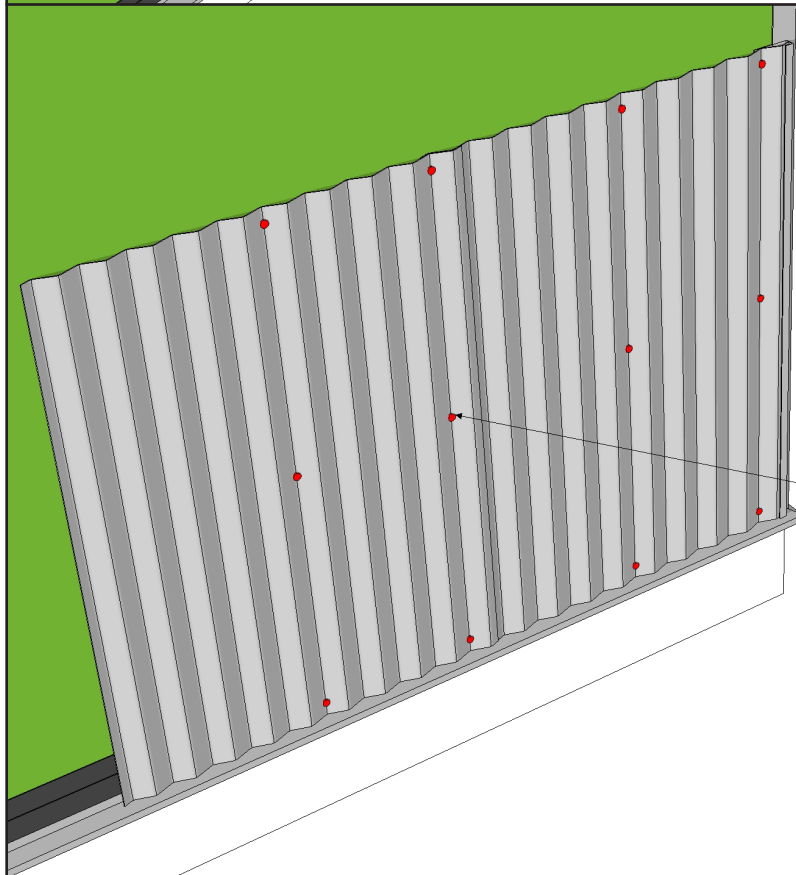

INSTALL METAL WAINSCOT:

- USE A CARPENTERS LEVEL TO ENSURE WAINSCOT IS LEVEL PRIOR TO INSTALLING ANY FASTENERS.

- DO NOT OVER DRIVE THE SCREWS! THIS WILL CAUSE DAMAGE TO THE NEOPRENE WASHER.

>> STEP 6:

FASTEN THE PANEL TO THE WALL BY FOLLOWING THE STEPS ILLUSTRATED IN FIG 6b. THE FIRST ROW OF FASTENERS WILL BE INSTALLED IN THE SHARED VALLEY WHERE THE PANELS OVERLAP.

LINE-UP SCREWS HORIZONTALLY WITH THE SCREWS INSTALLED DURING FIG 6b FOR THE BEST LOOK.

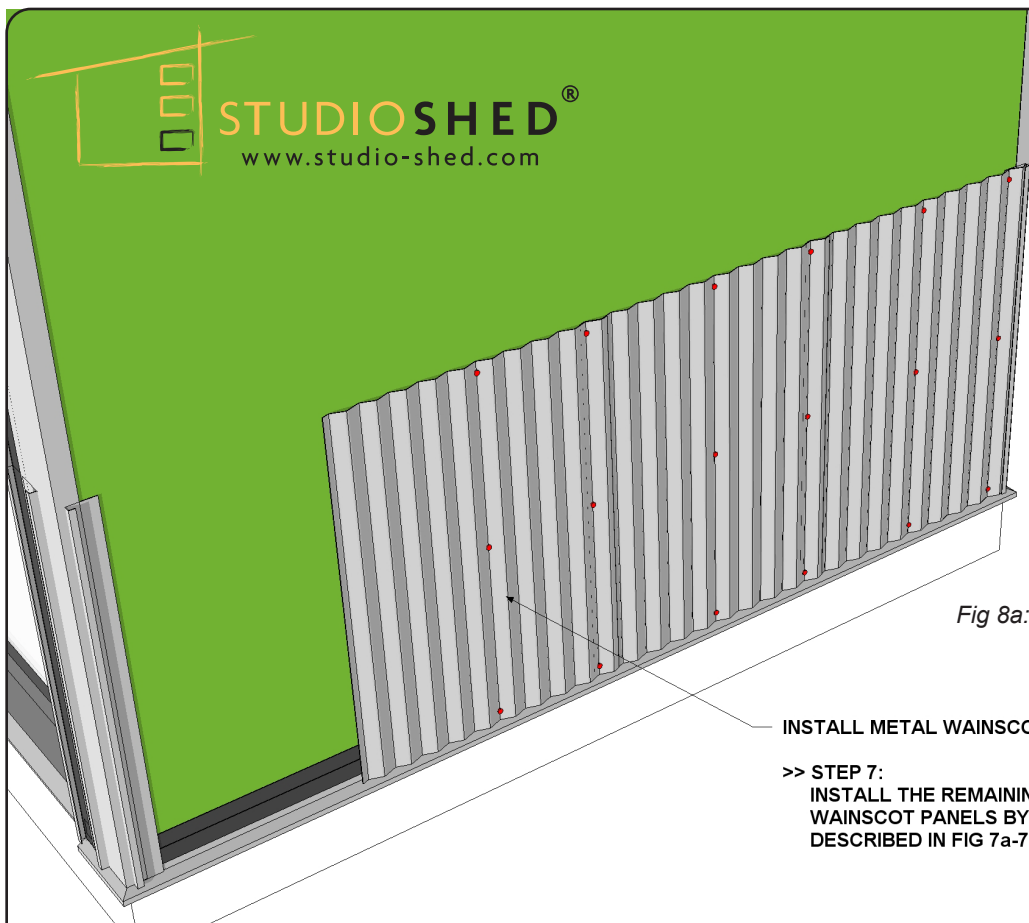

Fig 8a:

INSTALL METAL WAINSCOT:

>> STEP 7:
INSTALL THE REMAINING FULL SIZE PRE-CUT
WAINSCOT PANELS BY FOLLOWING THE METHODS
DESCRIBED IN FIG 7a-7b.

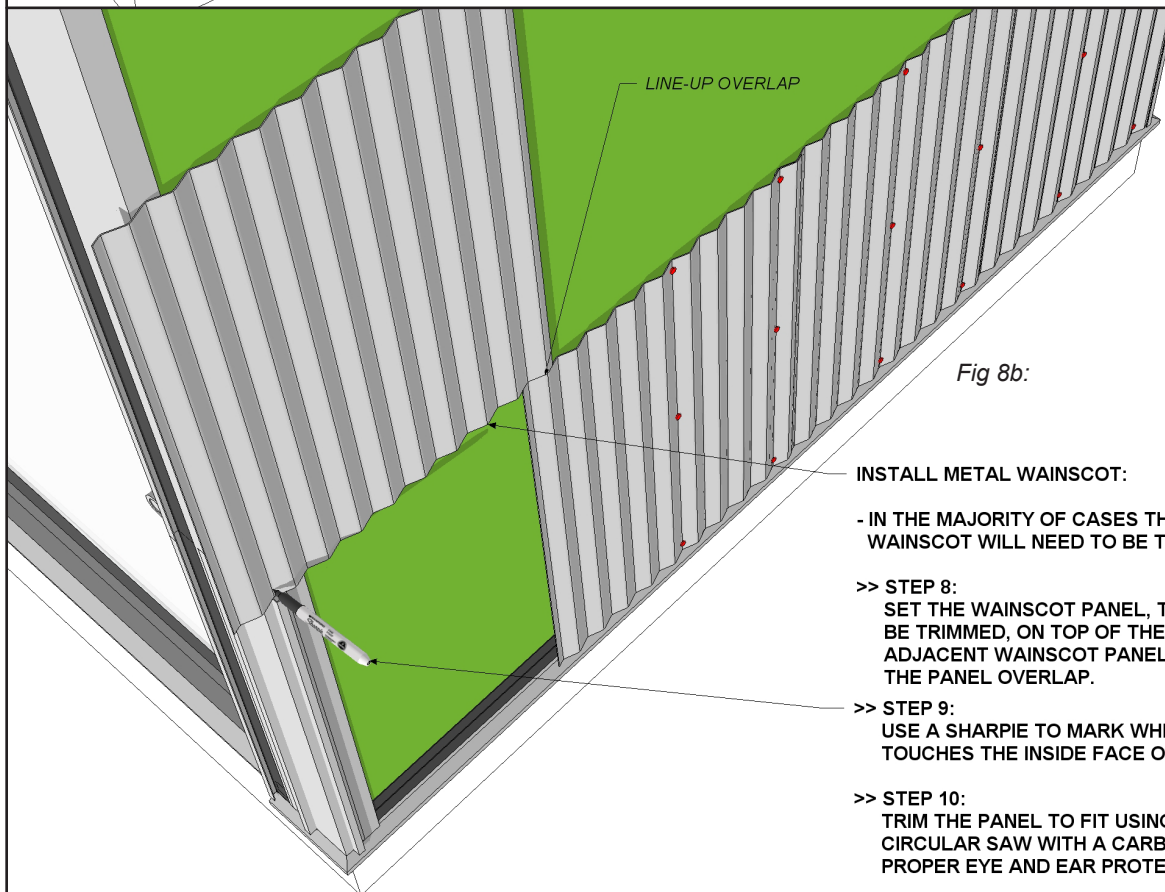

Fig 8b:

INSTALL METAL WAINSCOT:

- IN THE MAJORITY OF CASES THE LAST PIECE OF
WAINSCOT WILL NEED TO BE TRIMMED TO FIT.

>> STEP 8:
SET THE WAINSCOT PANEL, THAT WILL NEED TO
BE TRIMMED, ON TOP OF THE J-CHANNEL AND
ADJACENT WAINSCOT PANEL. BE SURE TO LINE-UP
THE PANEL OVERLAP.

>> STEP 9:
USE A SHARPIE TO MARK WHERE THE WAINSCOT
TOUCHES THE INSIDE FACE OF THE J-CHANNEL.

>> STEP 10:
TRIM THE PANEL TO FIT USING METAL SHEARS OR A
CIRCULAR SAW WITH A CARBIDE BLADE. WEAR
PROPER EYE AND EAR PROTECTION WHILE CUTTING!

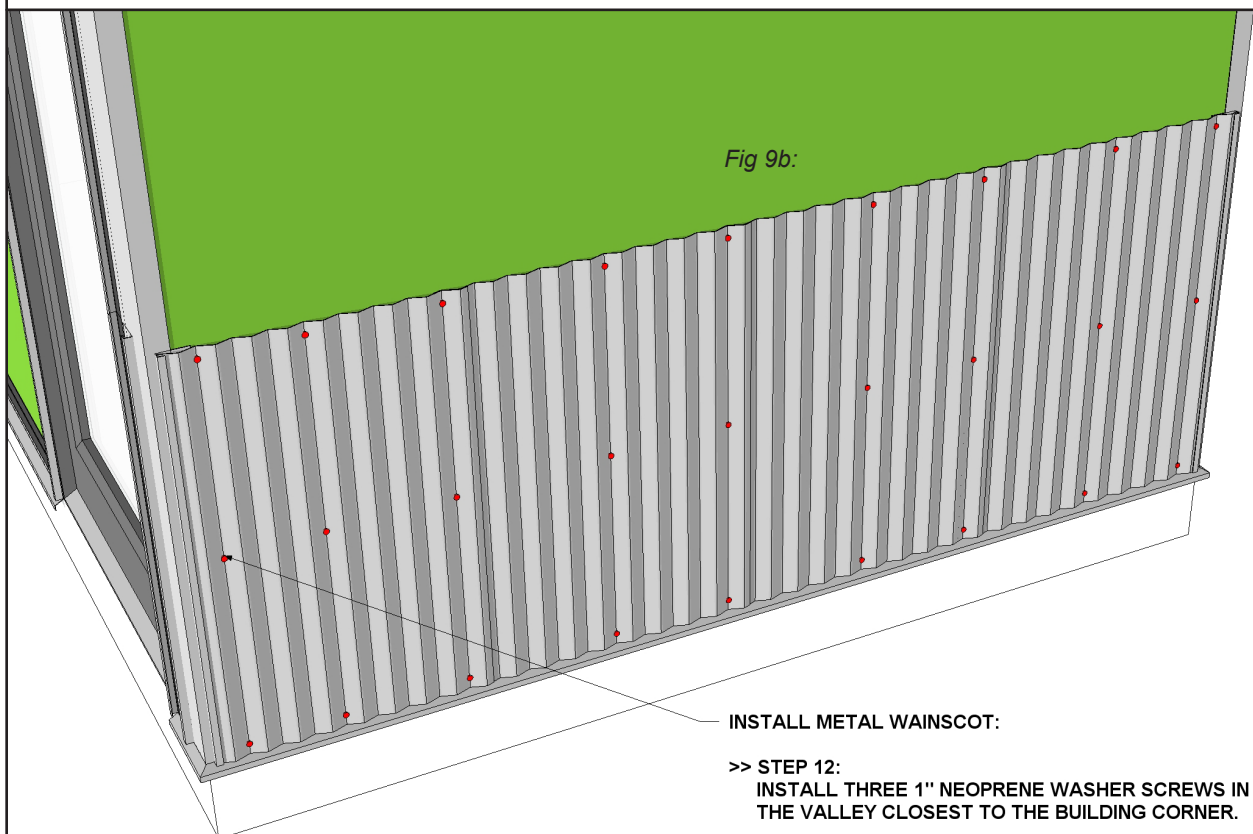
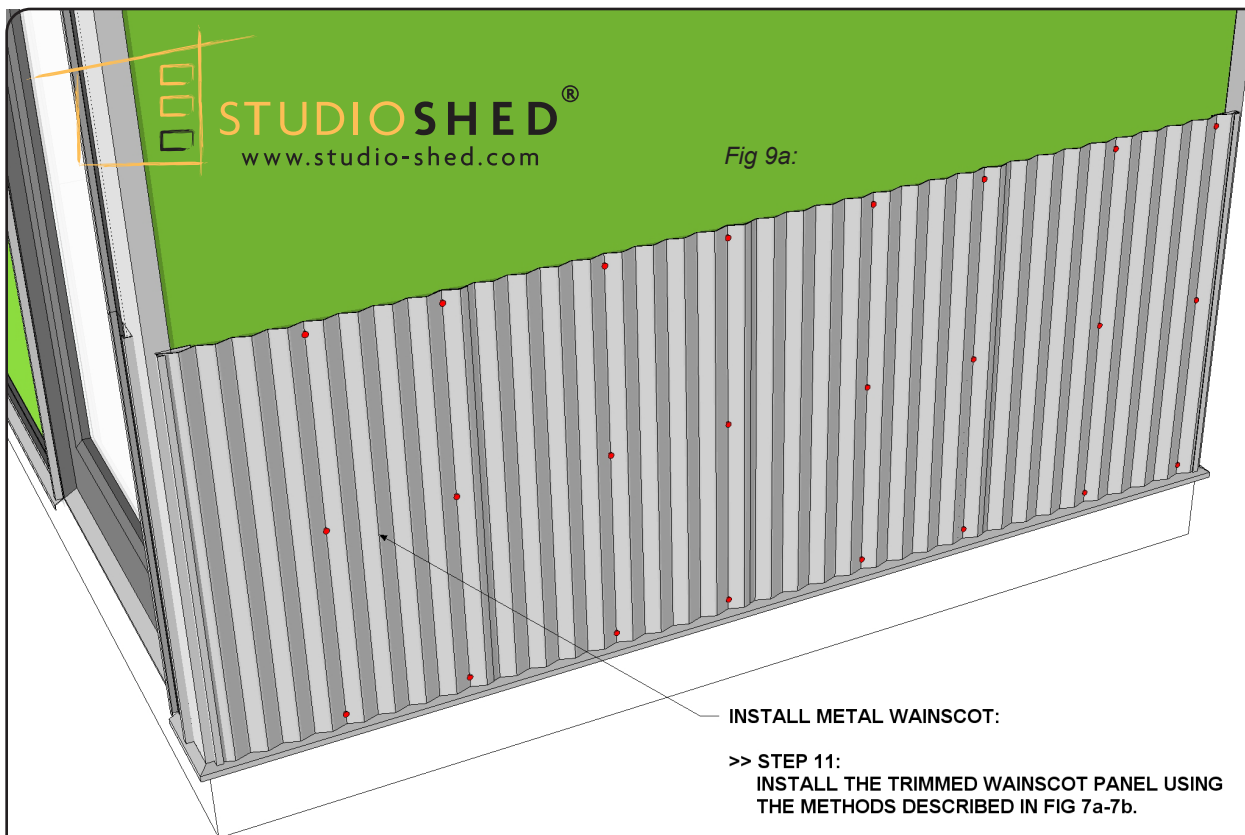

Fig 10a:

INSTALL METAL WAINSCOT:

>> **STEP 13:**
MEASURE AND CUT A PIECE OF WAINSCOT Z-CHANNEL (TRIM PROFILE 'L') TO FIT.

>> **STEP 14:**
PLACE THE Z-CHANNEL ON TOP OF THE WAINSCOT. USE A PNEUMATIC BRAD NAILER, WITH 3/4" GALVANIZED BRAD NAILS, TO SECURE THE Z-CHANNEL TO THE SHED. NAIL ~12" ON CENTER ALONG THE VERTICAL LEG OF THE Z-CHANNEL. USE A CARPENTERS LEVEL TO ENSURE THE Z-CHANNEL REMAINS LEVEL DURING INSTALLATION.

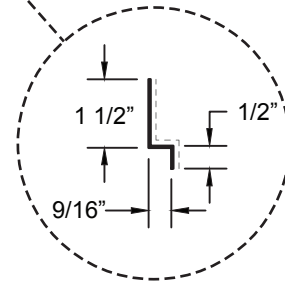

Fig 10b:

SIDING INSTALLATION:

- REFERENCE SIDING INSTALLATION GUIDE FOR INSTRUCTIONS ON HOW TO INSTALL BLOCK, PLANK OR BEETLE KILL.

- SIDING WILL START ABOVE THE TOP OF THE METAL WAINSCOT Z-CHANNEL.

- FOR THE BEST LOOK:

1. BLOCK SIDING - START 1/2" ABOVE THE TOP OF THE WAINSCOT Z-CHANNEL.
2. PLANK AND BEETLE KILL - START DIRECTLY ON TOP OF THE WAINSCOT Z-CHANNEL.

1/2" - BLOCK SIDING ONLY

BLOCK SIDING SHOWN